

# Schmutzfänger Baureihe ART3050/3059

- Welded flanged armature for cleaning neutral gaseous and liquid media
- Simple dismantling of the screen for cleaning
- Small loss of pressure due to favourable hydraulic form
- Technical delivery conditions to EN 12266 1,2
- Face to face per EN 558-1, basic series 1 (DIN 3202, F1)
- Strength test / Pressure testing to EN 12266 - P10, P11
- Flanged connections EN 1092-1 PN 6/10/16/25
- Pmax = 6/10/16/25 bar of overpressure

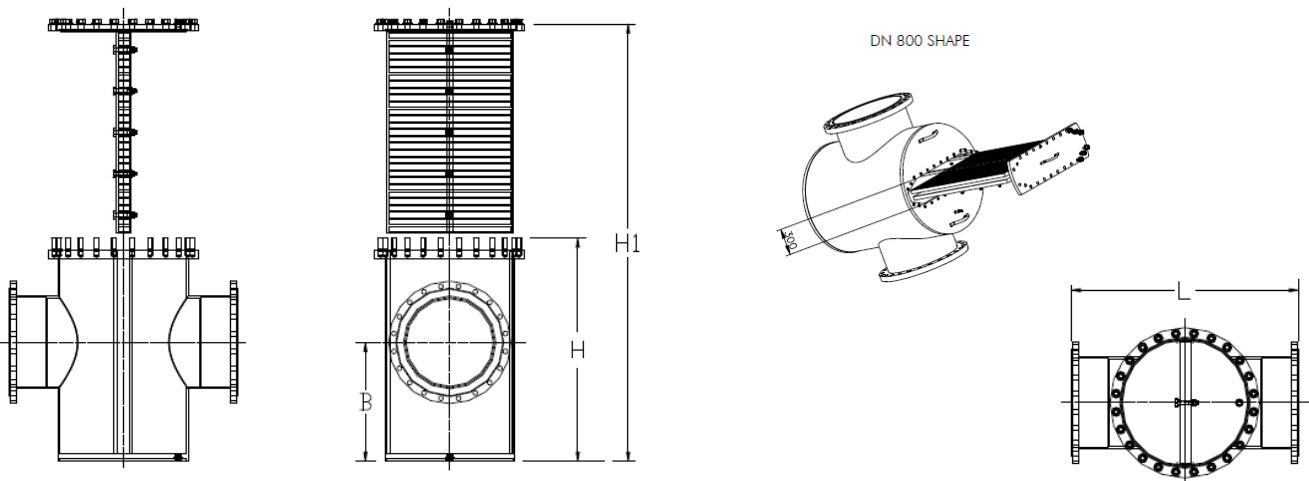

DN	Strainer dimensions				Standard screen		Weight (PN10)
	L	H	H1	B	Kv (m³/h)	ζ (-)	kg
150	480	630	1230	400	489	4.00	81
200	600	795	1550	560	868	3.92	123
250	730	950	1855	670	1358	3.98	203
300	850	1045	2005	610	1890	4.12	300
350	980	1090	2135	580	2225	4.39	445
400	1100	1090	2135	580	3000	4.20	460
450	1200	1215	2392	650	3808	4.25	660
500	1250	1215	2392	650	4821	4.09	700
600	1450	1340	2649	720	6939	4.19	1169
700	1650	1420	2810	750	9519	4.12	1337
800	1850	1600	3280	840	12511	4.19	2083

All dimensions are in mm.

Strainer screen	
Material	Stainles steel / W.Nr. 1.4301 / AISI 304
	Standard screen / Normalsieb
Light mesh width mm	2.00
Number of meshses n/cm²	15.5

PN (bar)	6	10/16	25
Testing presure	10	16/25	37,5

**STRAINER TYPE**       , **PN/ANSI**   , **DN**

Strainer, T-shape **300**  
 Body / cover material  
 St 37-2 / W.Nr.1.0038 **32**  
 X5 - CrNi 18 10 / W.Nr.1.4301 **31**  
 X6 - CrNiMoTi 17122 / W.Nr.1.4571 **42**

Seal material  
 NBR - (Perbunan), Tmax. = 90°C **P**  
 EPDM - (Nordel), Tmax. = 120°C **E**

Pressure rating  
 PN 06 **06**  
 PN 10 **10**  
 PN 16 **16**  
 PN 25 **25**  
 ANSI 150 **150**

Nominal size  
**DN 150 - 800**

Other materials are also available on agreement and on placing the order.